

Corso di Tecnica delle costruzioni e laboratorio, a.a. 2023-2024

Il progetto da svolgere è quello abbinato al numero del gruppo

Gruppo	Cognome	Nome	Codice	Matricola
1	Bisignani	Chiara Maria	10000	021268
	Cavallaro	Lucrezia	10000	021883
2	Rigoli	Ivano	1000	006806
	Assennato	Raffaele Samuel	1000	006923
3	Palazzo	Mattia	1000	006910
	Putzu	Maciej Robert	1000	006946
4	Greco	Lisa	1000	020857
	Ursino	Alessia	1000	021258
5	Giangreco	Enrico	1000	021368
	Saglimbene	Giuseppe	1000	021362
6	Carlino	Roberta	O58	000732
	Ragonese	Salvatore	O58	000119
7	Gugliuzzo	Aurora	1000	006681
	Carroccio	Giulia	1000	004612
8	Amas	Martina	1000	021931
	Battaglia	Eleonora Maria	1000	021224
9	Scorciapino	Rebecca	1000	014459
10	Ciccazzo	Lorenzo Giorgio	1000	021351
	Coco	Alfredo	1000	021424
11	Puccio	Giuseppe	O58	000736
	Lentini	Pierangelo	O58	000708
12	Leanza	Luigi	O58	000565
13	Schillaci	Gjnevra	1000	007816
	Boscarino	Martina	1000	016426

1. Cognome:

Nome:

matr.:

n. 001

2. Cognome:

Nome:

matr.:

Località: Palmi (vedi immagine per i dettagli)

Tipo di trave reticolare tipologia 3

Dati geometrici $L_1 = 5.20$ m $L_2 = 15.00$ m

Possibili travature reticolari

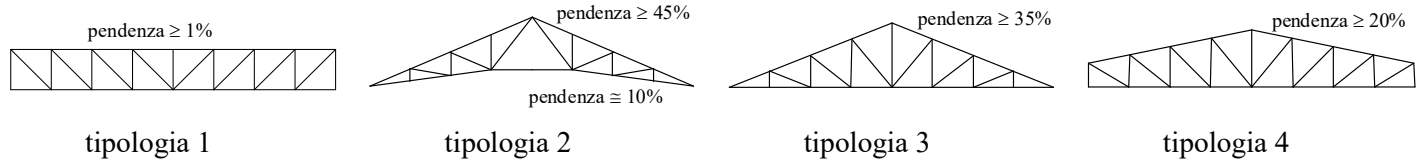

Carpenteria copertura

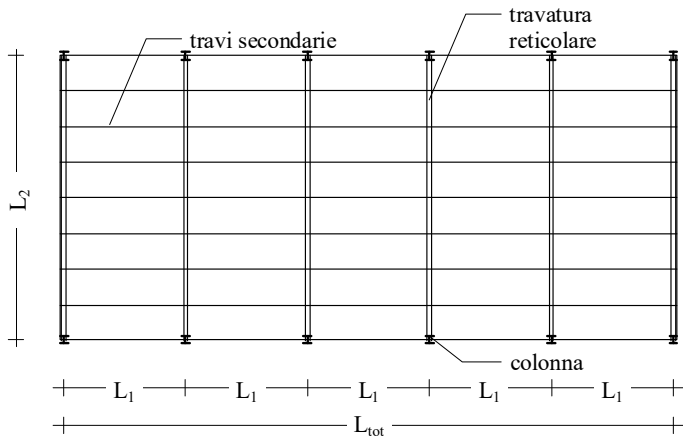

Sezione trasversale

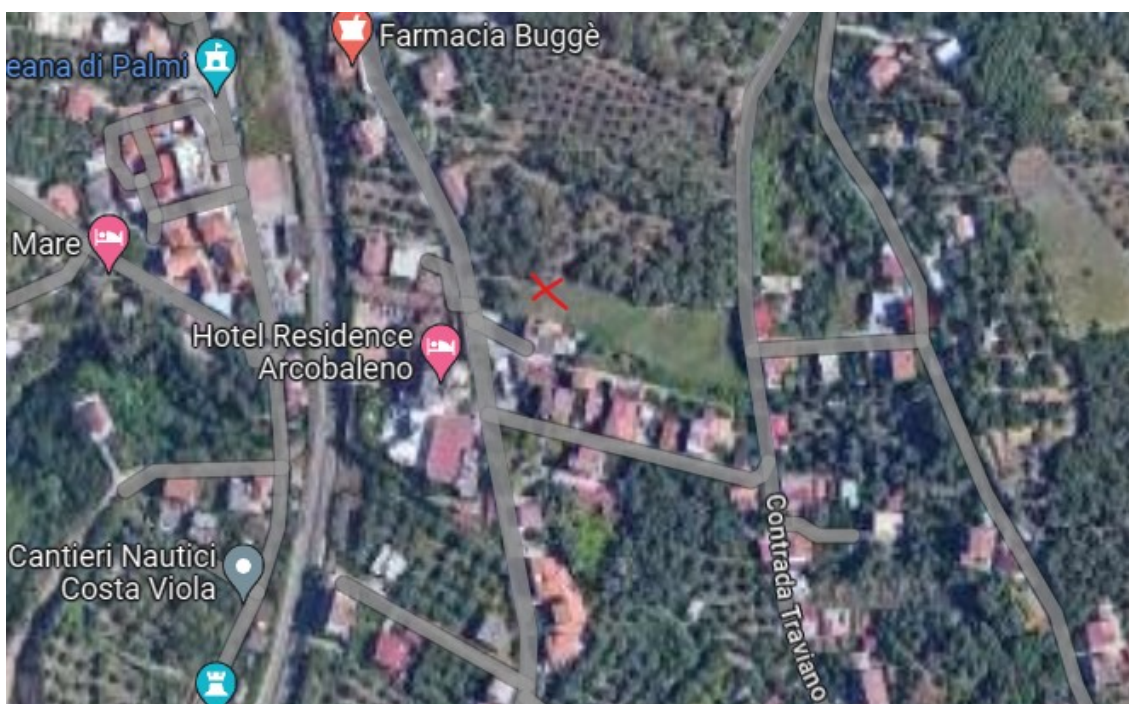
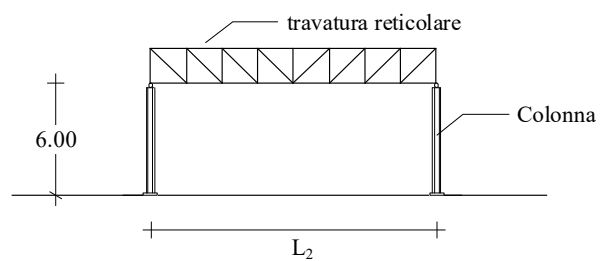

1. Cognome:

Nome:

matr.:

n. 002

2. Cognome:

Nome:

matr.:

Località: Peschici (vedi immagine per i dettagli)

Tipo di trave reticolare tipologia 3

Dati geometrici $L_1 = 4.80\text{ m}$ $L_2 = 16.00\text{ m}$

Possibili travature reticolari

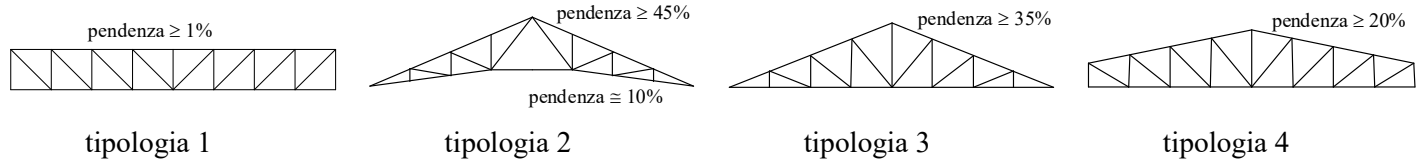

Carpenteria copertura

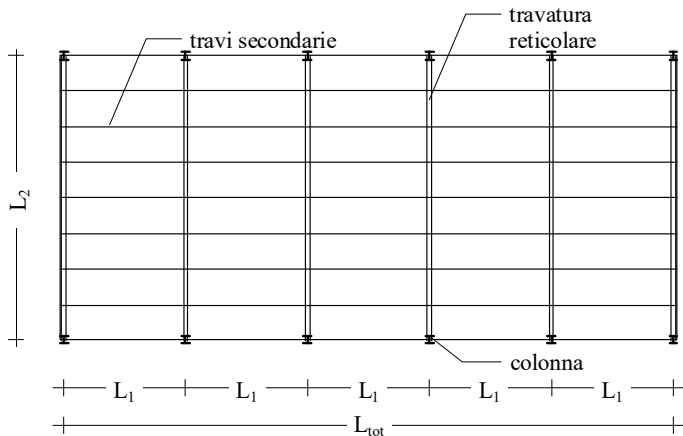

Sezione trasversale

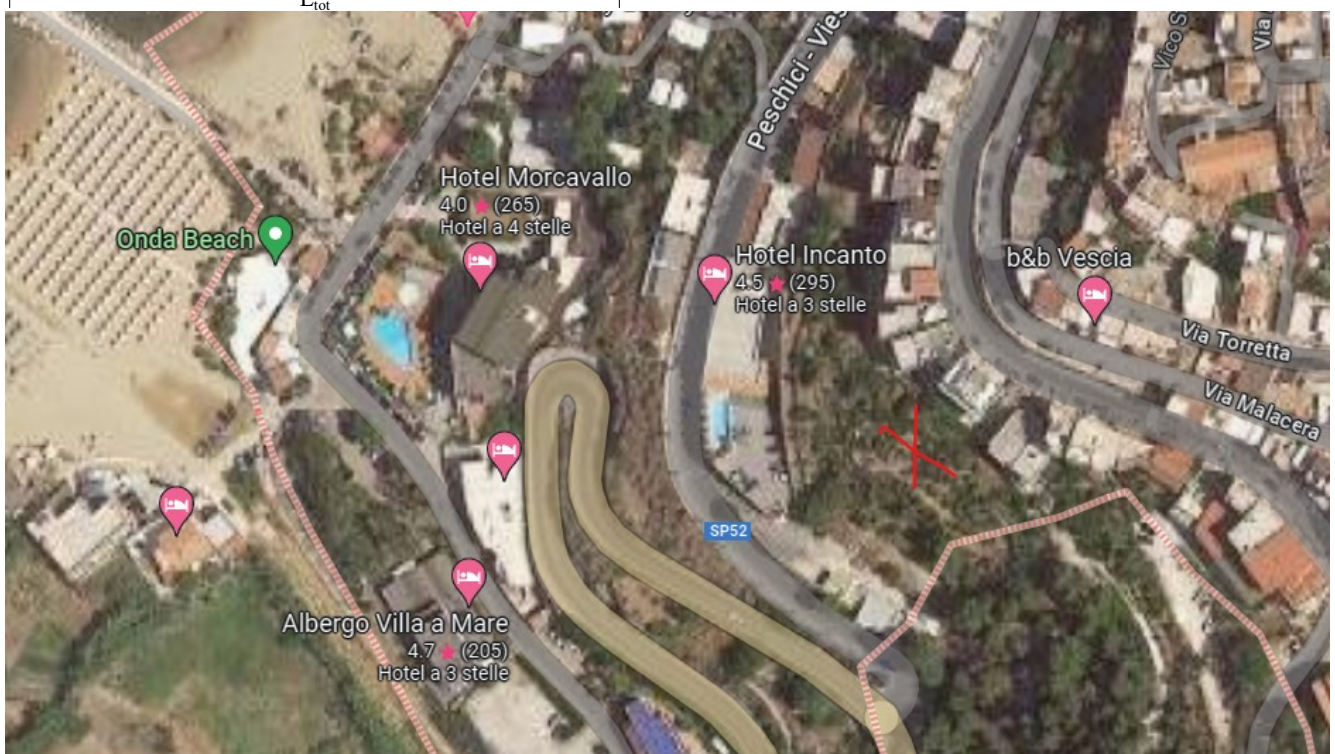
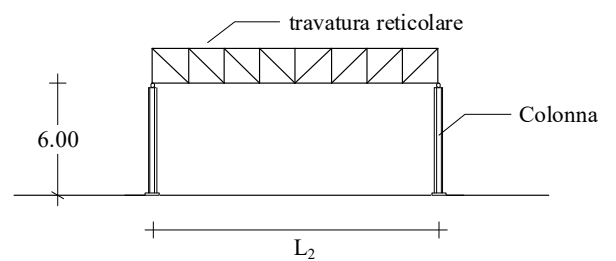

1. Cognome:

Nome:

matr.:

n. 003

2. Cognome:

Nome:

matr.:

Località: Lamezia Terme (vedi immagine per i dettagli)

Tipo di trave reticolare

tipologia 2

Dati geometrici

$L_1 = 5.80$ m

$L_2 = 18.90$ m

Possibili travature reticolari

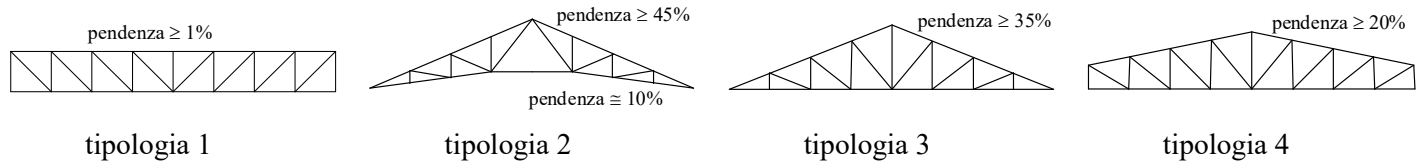

Carpenteria copertura

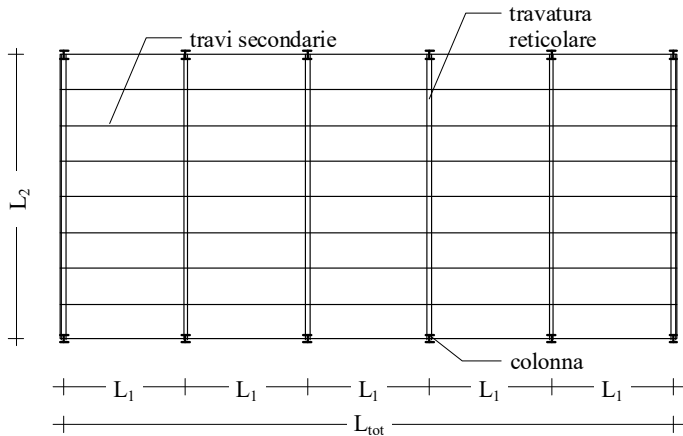

Sezione trasversale

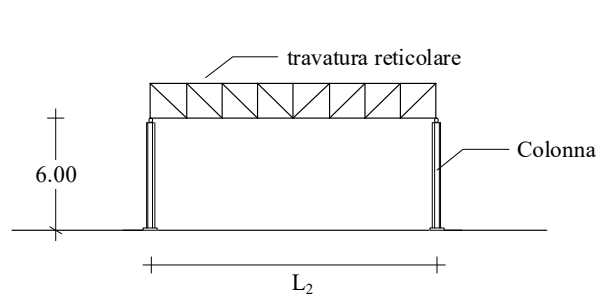

1. Cognome:

Nome:

matr.:

n. 004

2. Cognome:

Nome:

matr.:

Località: Parma (vedi immagine per i dettagli)

Tipo di trave reticolare tipologia 4

Dati geometrici $L_1 = 4.80$ m $L_2 = 15.00$ m

Possibili travature reticolari

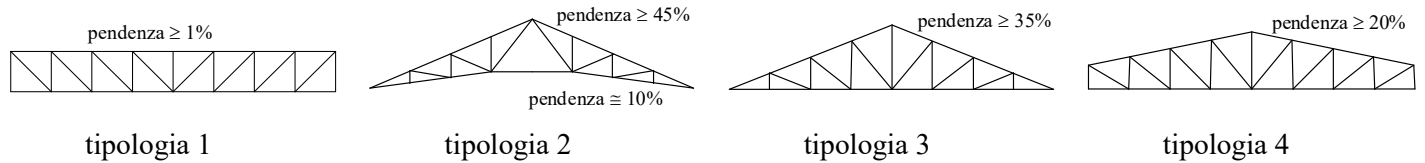

Carpenteria copertura

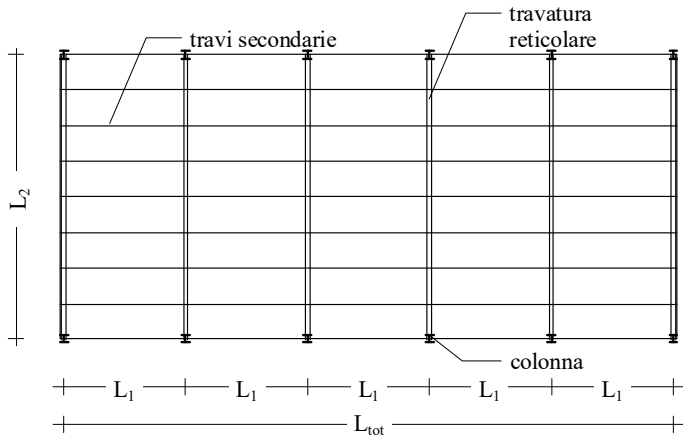

Sezione trasversale

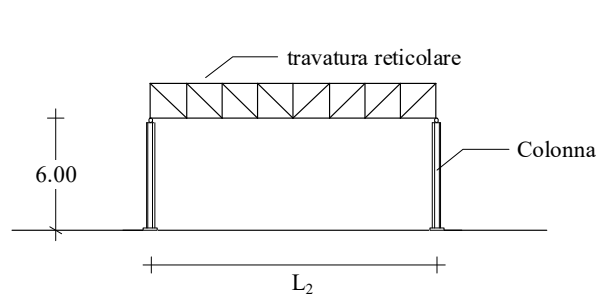

1. **Cognome:**

Nome:

matr.:

n. 005

2. **Cognome:**

Nome:

matr.:

Località: Porretta Terme (vedi immagine per i dettagli)

Tipo di trave reticolare tipologia 4

Dati geometrici $L_1 = 5.80 \text{ m}$ $L_2 = 18.00 \text{ m}$

Possibili travature reticolari

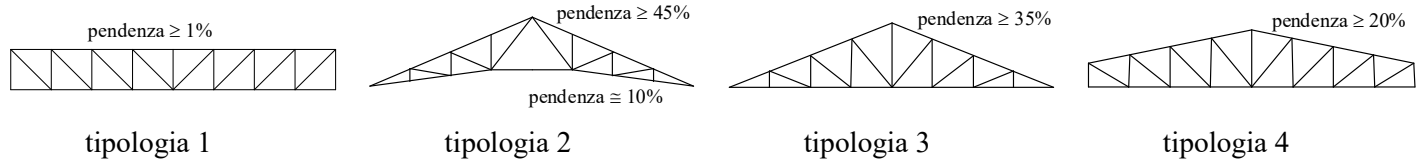

Carpenteria copertura

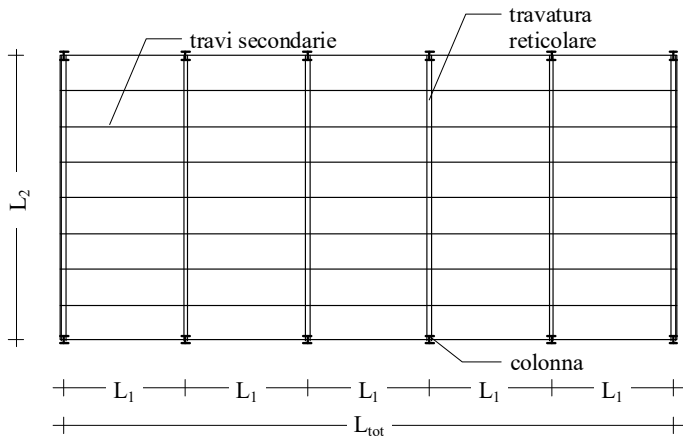

Sezione trasversale

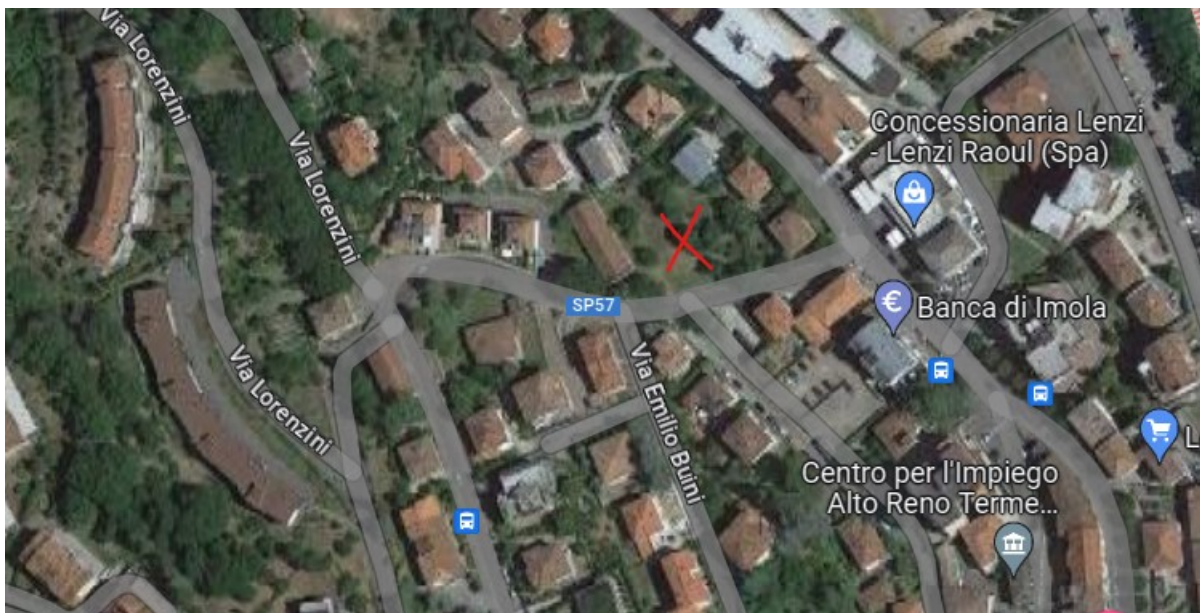
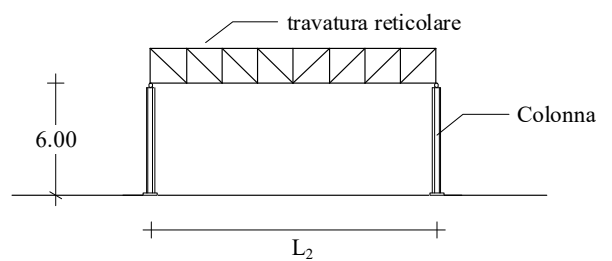

1. **Cognome:**

Nome:

matr.:

n. 006

2. **Cognome:**

Nome:

matr.:

Località: Merano (vedi immagine per i dettagli)

Tipo di trave reticolare tipologia 2

Dati geometrici $L_1 = 6.00$ m $L_2 = 18.00$ m

Possibili travature reticolari

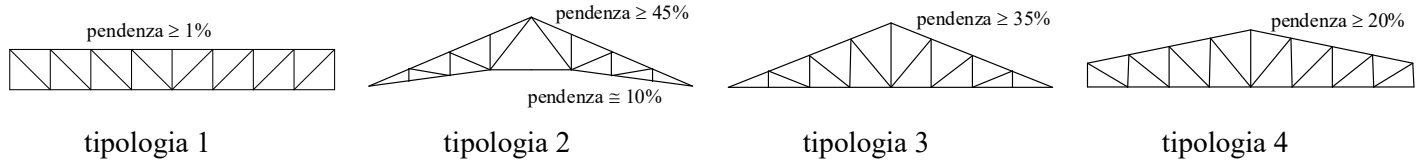

Carpenteria copertura

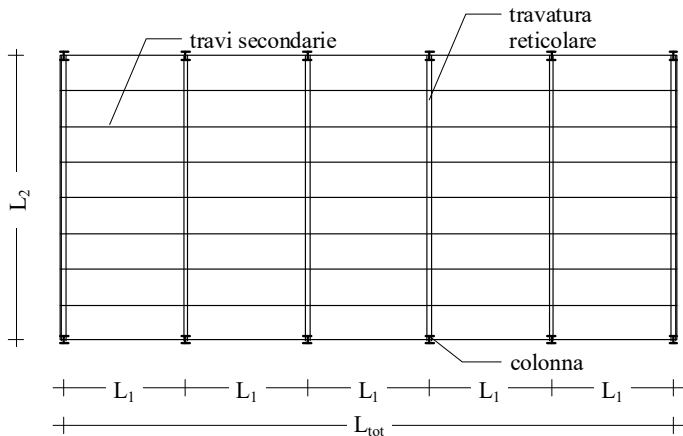

Sezione trasversale

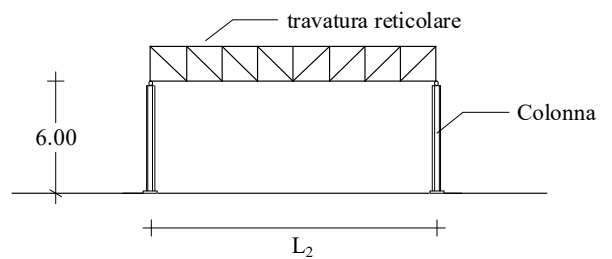

1. **Cognome:**

Nome:

matr.:

n. 007

2. **Cognome:**

Nome:

matr.:

Località: Sesto San Giovanni (MI) (vedi immagine per i dettagli)

Tipo di trave reticolare tipologia 3

Dati geometrici $L_1 = 5.60$ m $L_2 = 15.00$ m

Possibili travature reticolari

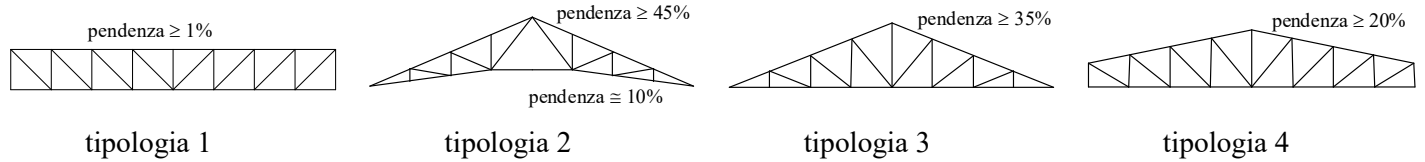

Carpenteria copertura

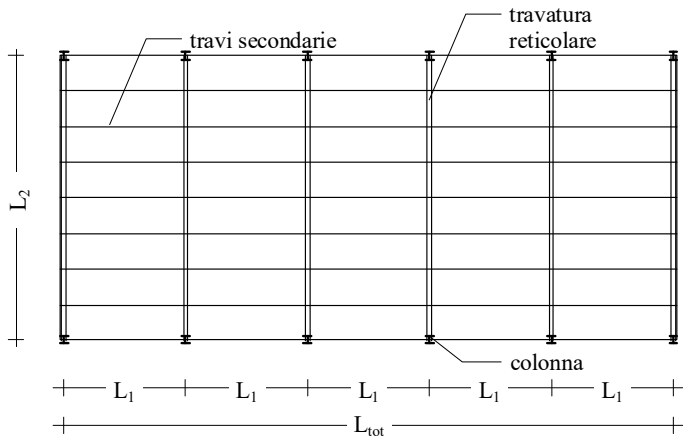

Sezione trasversale

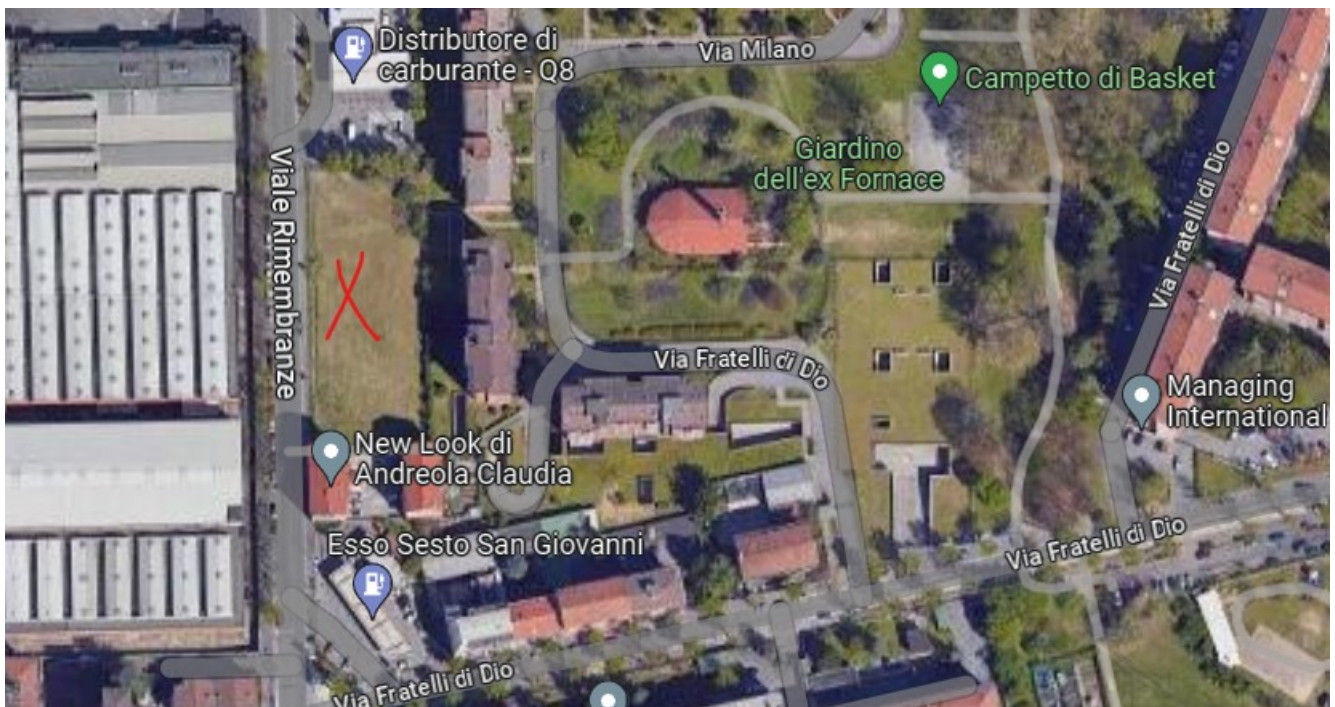
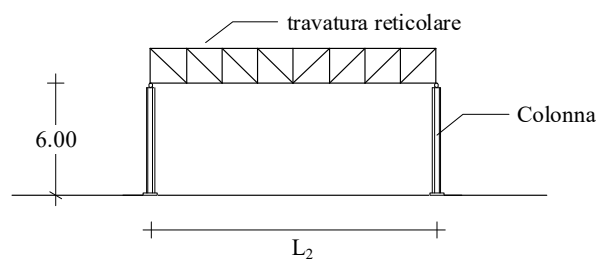

1. Cognome:

Nome:

matr.:

n. 008

2. Cognome:

Nome:

matr.:

Località: San Cataldo (vedi immagine per i dettagli)

Tipo di trave reticolare tipologia 1

Dati geometrici $L_1 = 5.20$ m $L_2 = 15.00$ m

Possibili travature reticolari

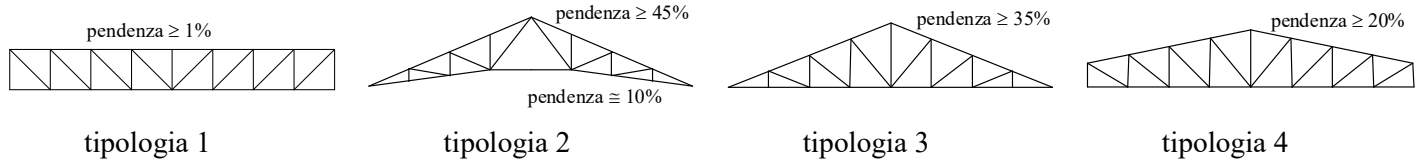

Carpenteria copertura

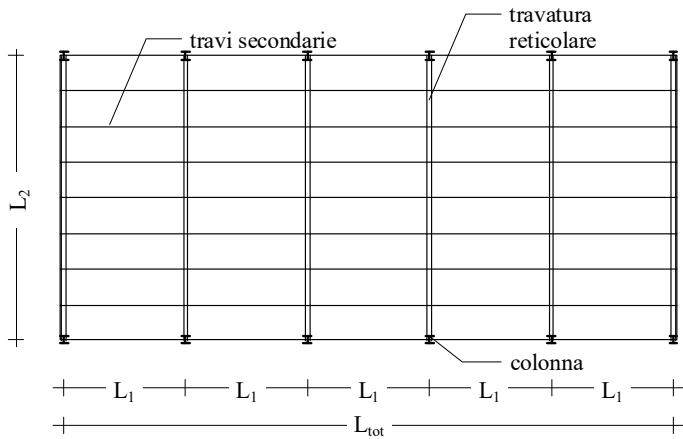

Sezione trasversale

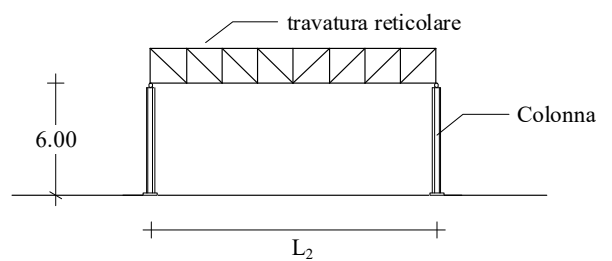

1. **Cognome:**

Nome:

matr.:

n. 009

2. **Cognome:**

Nome:

matr.:

Località: Monopoli (vedi immagine per i dettagli)

Tipo di trave reticolare tipologia 3

Dati geometrici $L_1 = 5.00$ m $L_2 = 18.90$ m

Possibili travature reticolari

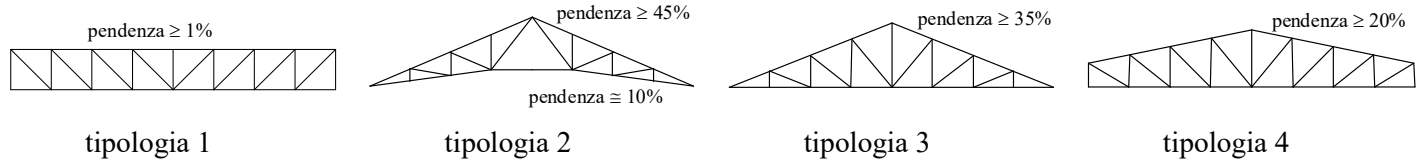

Carpenteria copertura

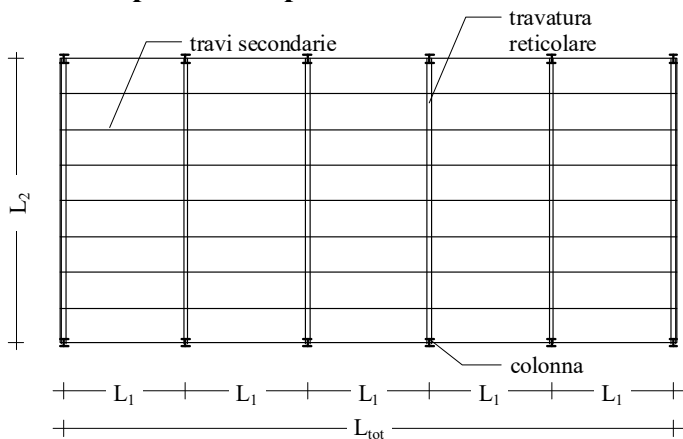

Sezione trasversale

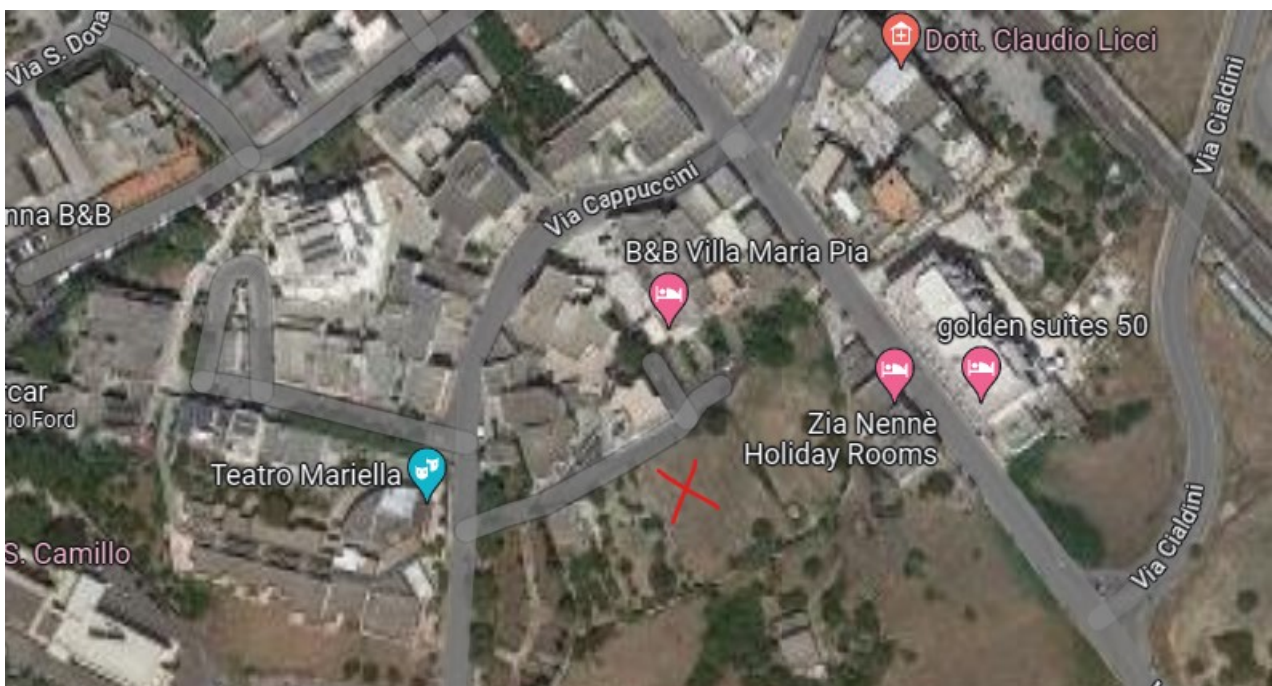
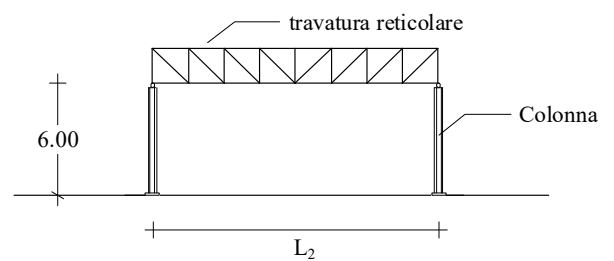

1. **Cognome:**

Nome:

matr.:

n. 010

2. **Cognome:**

Nome:

matr.:

Località: Tempio Pausania (vedi immagine per i dettagli)

Tipo di trave reticolare tipologia 3

Dati geometrici $L_1 = 5.20$ m $L_2 = 17.00$ m

Possibili travature reticolari

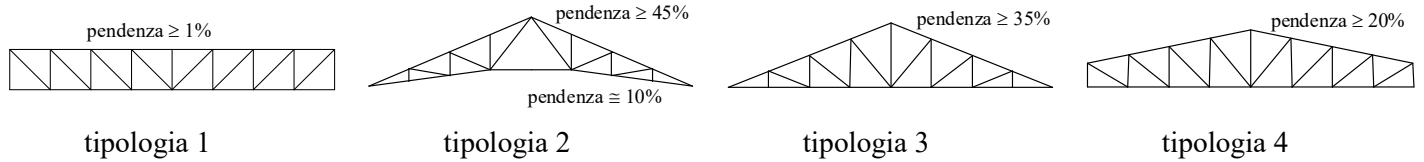

Carpenteria copertura

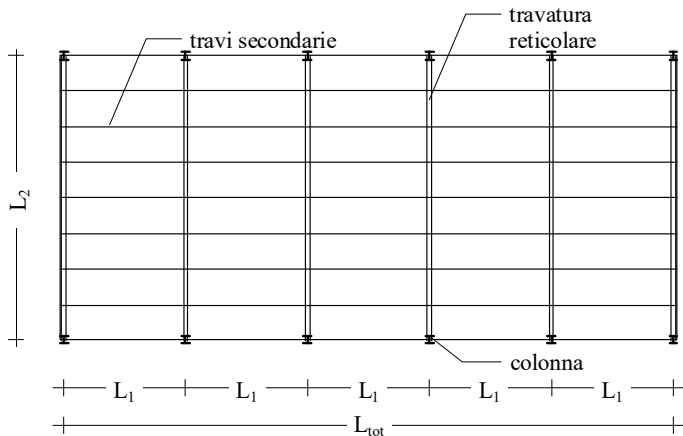

Sezione trasversale

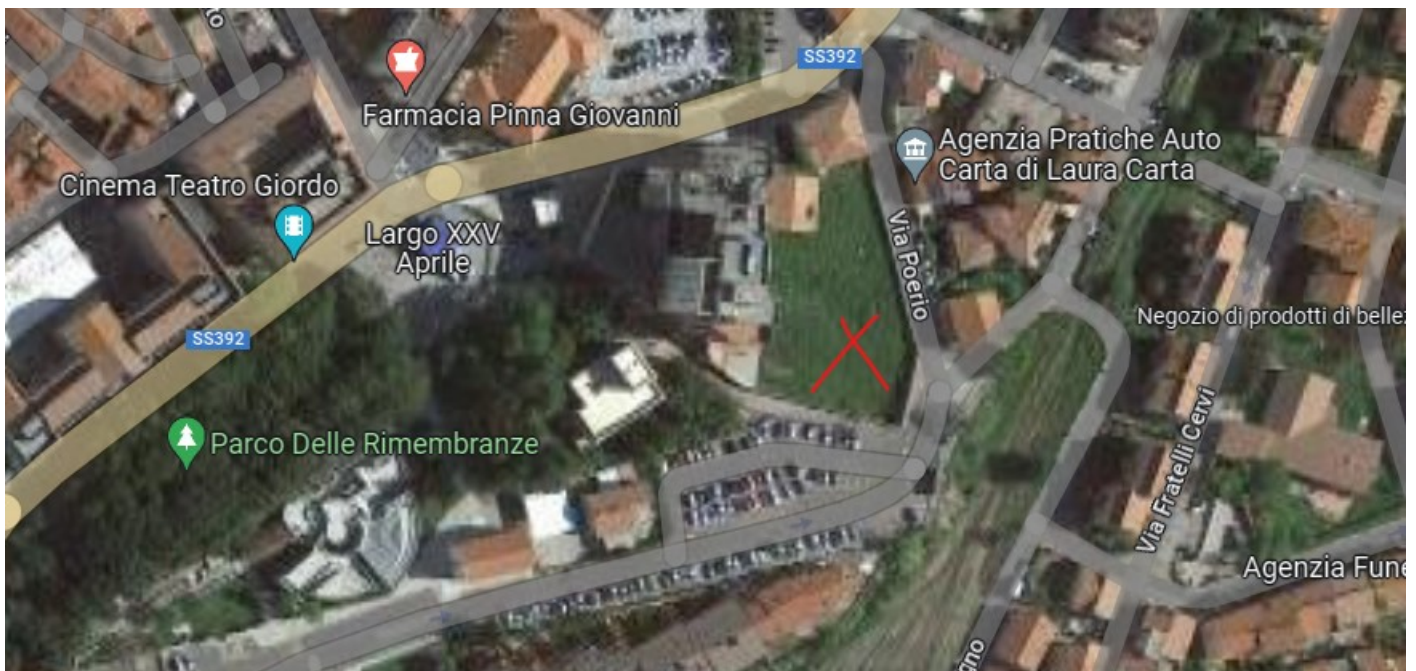
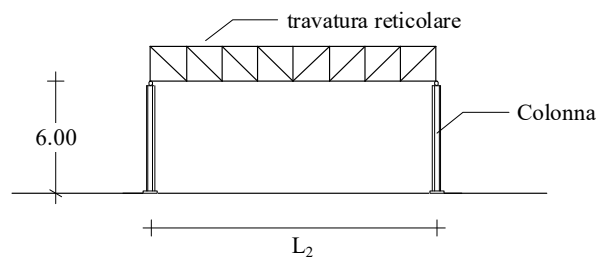

1. Cognome:

Nome:

matr.:

n. 011

2. Cognome:

Nome:

matr.:

Località: Partanna (vedi immagine per i dettagli)

Tipo di trave reticolare

tipologia 1

Dati geometrici

$L_1 = 5.00$ m

$L_2 = 16.00$ m

Possibili travature reticolari

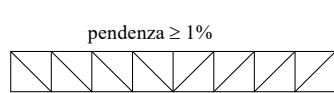

tipologia 1

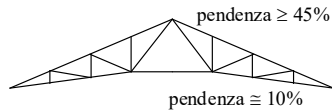

tipologia 2

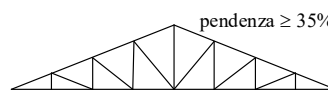

tipologia 3

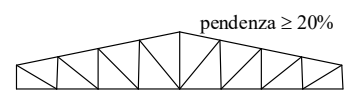

tipologia 4

Carpenteria copertura

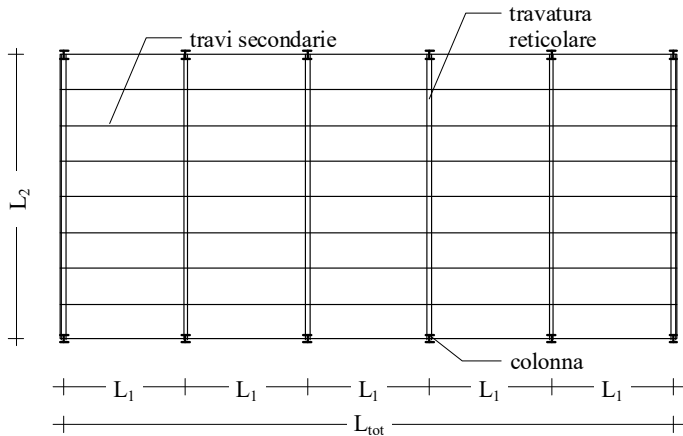

Sezione trasversale

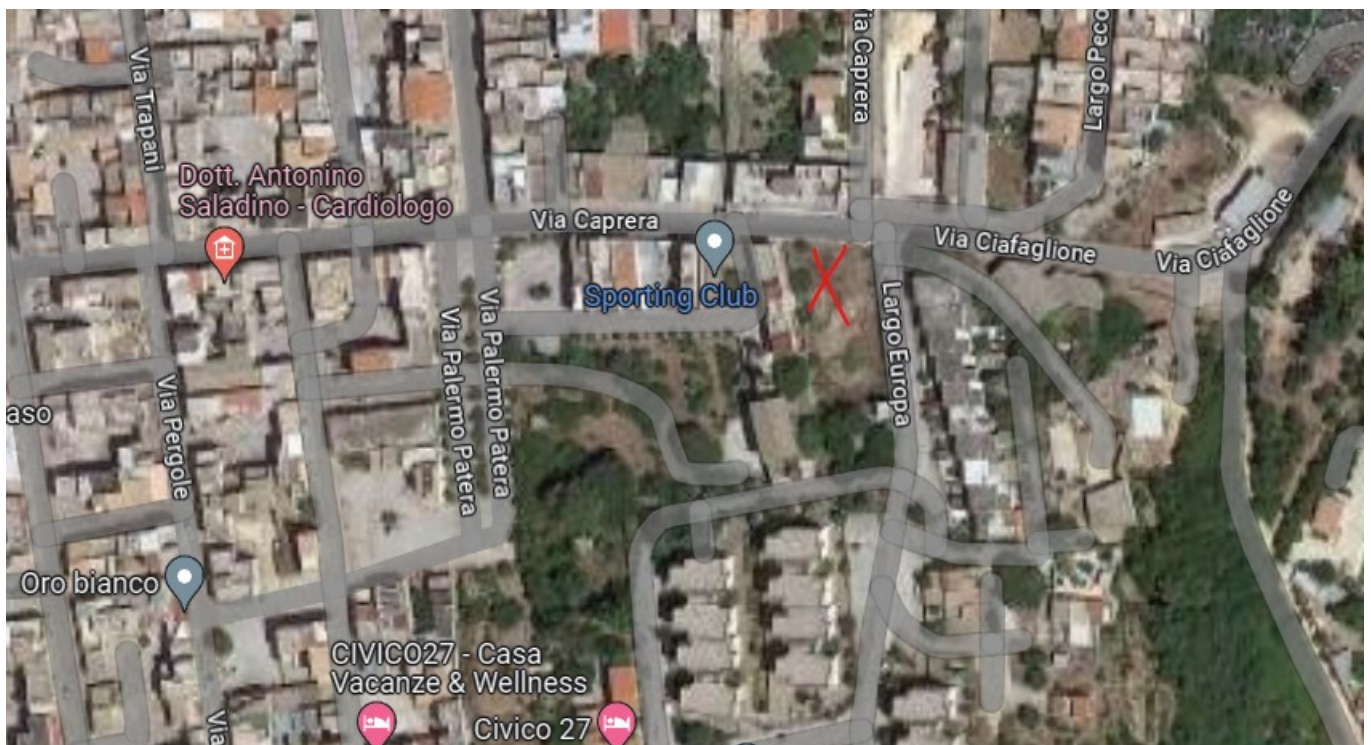
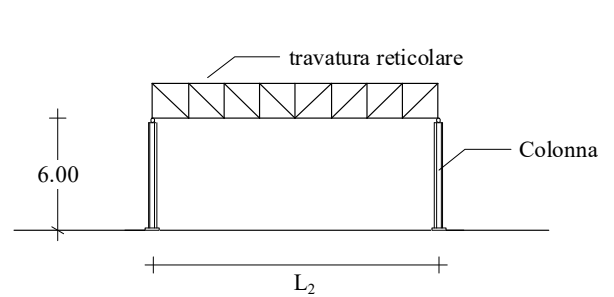

1. Cognome:

Nome:

matr.:

n. 012

2. Cognome:

Nome:

matr.:

Località: Tre Fontane (vedi immagine per i dettagli)

Tipo di trave reticolare tipologia 3

Dati geometrici $L_1 = 6.00$ m $L_2 = 18.00$ m

Possibili travature reticolari

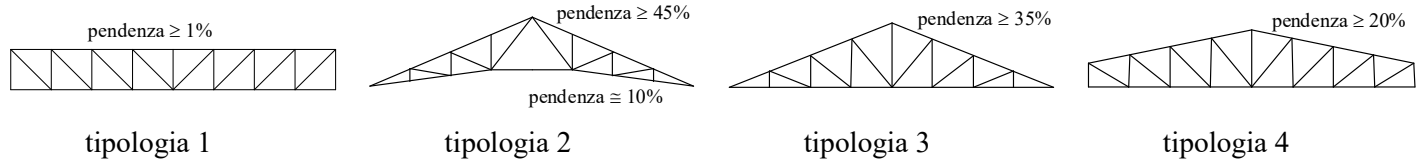

Carpenteria copertura

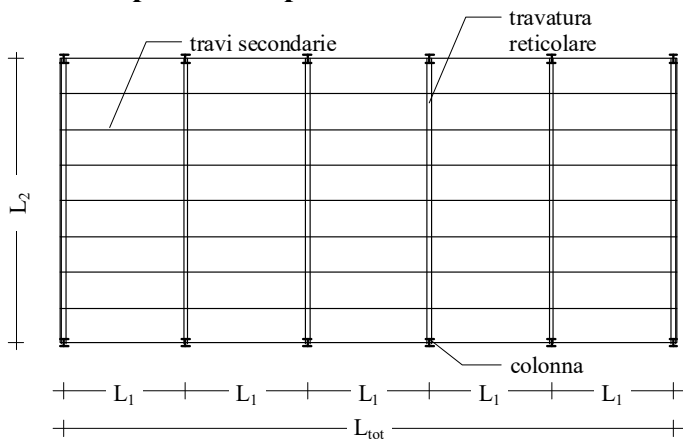

Sezione trasversale

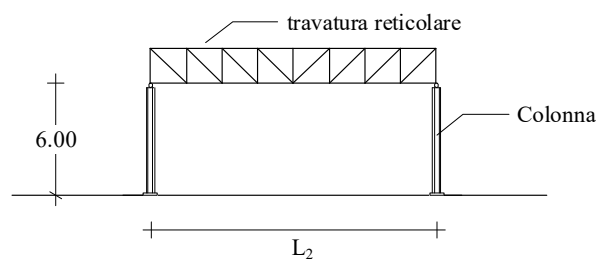

1. Cognome:

Nome:

matr.:

n. 013

2. Cognome:

Nome:

matr.:

Località: Castellammare del Golfo (vedi immagine per i dettagli)

Tipo di trave reticolare tipologia 2

Dati geometrici $L_1 = 4.80$ m $L_2 = 18.00$ m

Possibili travature reticolari

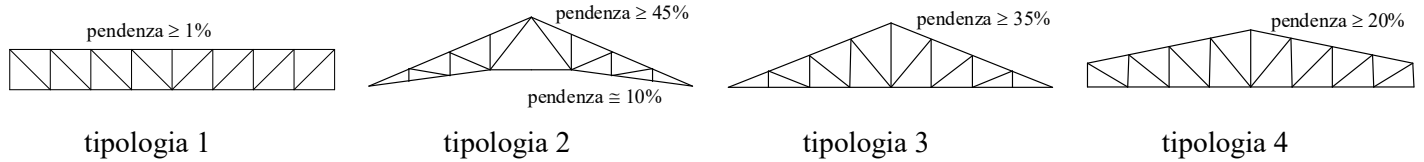

Carpenteria copertura

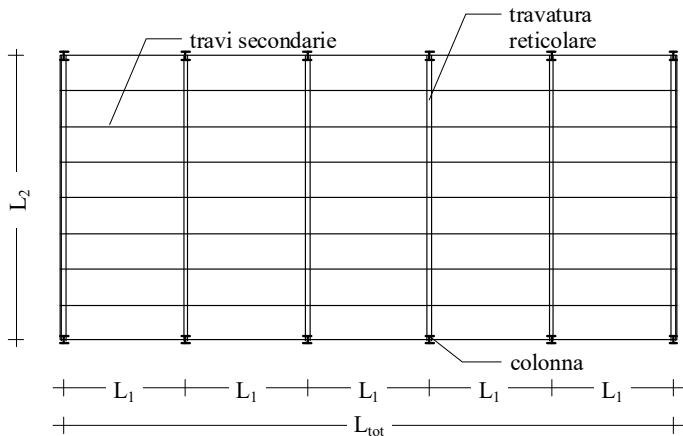

Sezione trasversale

